

CLARENCE DEBELLE
 Personal Real Estate Corporation
 West Vancouver's Luxury Home Real Estate Agent!



Tel.: 604-726-5780
 www.clarencedebelle.com

1149 EYREMOUNT DRIVE, WEST VANCOUVER

TOTALS*	
MAIN FLOOR:	4,460 sq.ft.
UPPER FLOOR:	3,602 sq.ft.
LOWER FLOOR:	2,302 sq.ft.
TOTAL:	10,364 sq.ft.
GARAGE:	792 sq.ft.
GRAND TOTAL:	11,156 sq.ft.

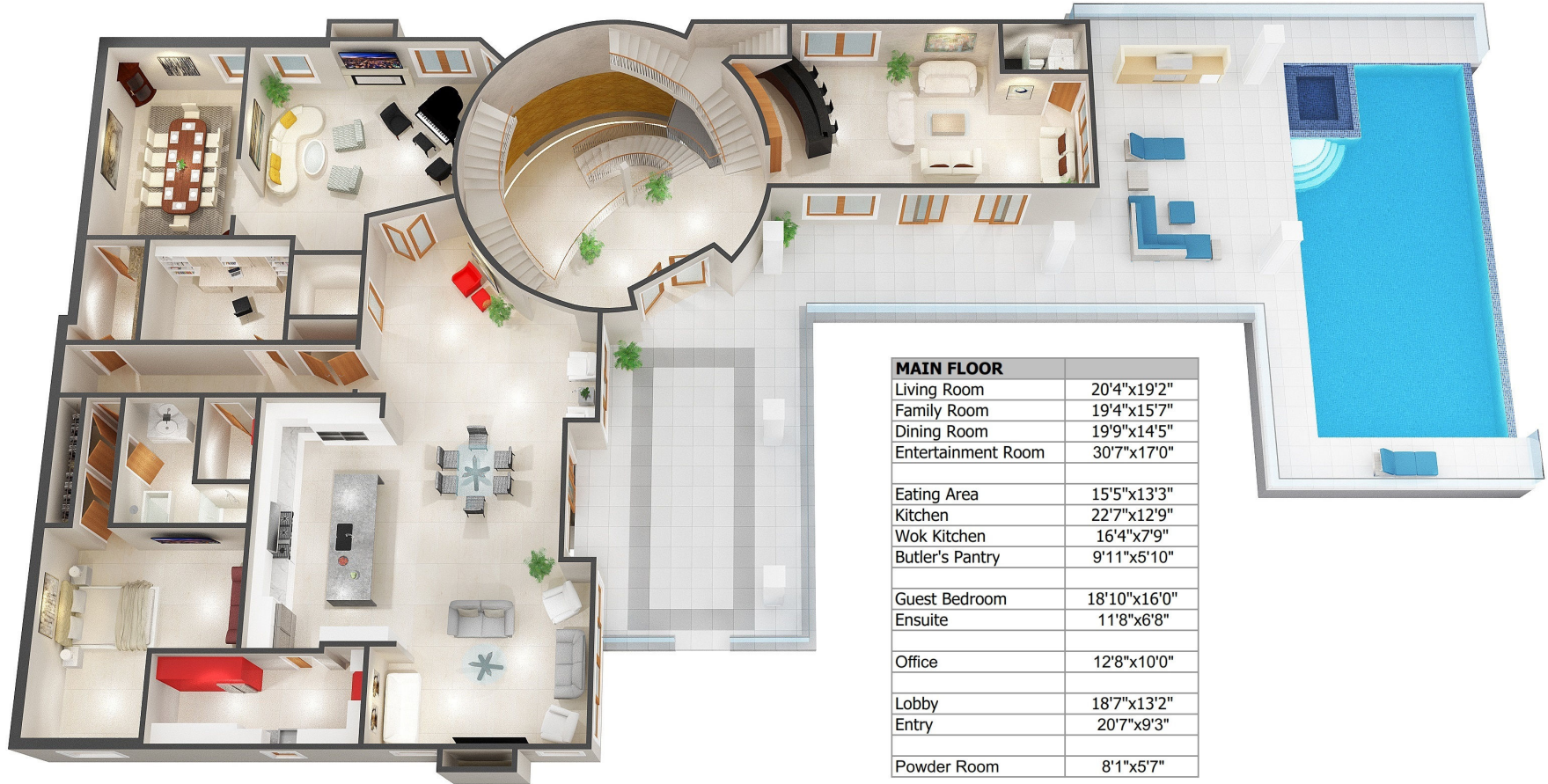

MAIN FLOOR	
Living Room	20'4"x19'2"
Family Room	19'4"x15'7"
Dining Room	19'9"x14'5"
Entertainment Room	30'7"x17'0"
Eating Area	15'5"x13'3"
Kitchen	22'7"x12'9"
Wok Kitchen	16'4"x7'9"
Butler's Pantry	9'11"x5'10"
Guest Bedroom	18'10"x16'0"
Ensuite	11'8"x6'8"
Office	12'8"x10'0"
Lobby	18'7"x13'2"
Entry	20'7"x9'3"
Powder Room	8'1"x5'7"

*All room dimensions, names and square footage for this house were based on provided blueprints and other sources and may vary from the dimensions and names of the rooms and square footage of the house as built. Square Footage may include lower height ceiling areas, openings in floors not associated with stairs, or openings in floors exceeding the area of associated stairs, or unfinished areas. E&OE

Please note this floor plan is approximate and is for illustrative purposes only. This floor plan is to be used as a guide only. Architectural elements may vary from rendering shown. All renderings and floor plans are artists' representations only, and not always to exact scale. Buyer to verify all information, floor plans and renderings. E&OE.