

1155 Eyremount Drive, West Vancouver, B.C.

Totals**

Main/Upper Level: 2,011 sq. ft.
 Lower Level: 1,916 sq. ft.
 Total: 3,927 sq. ft.

Other Areas**

Garage: 545 sq. ft.
 Workshop: 232 sq. ft.
 Pool Mech: 73 sq. ft.
 Total: 850 sq. ft.

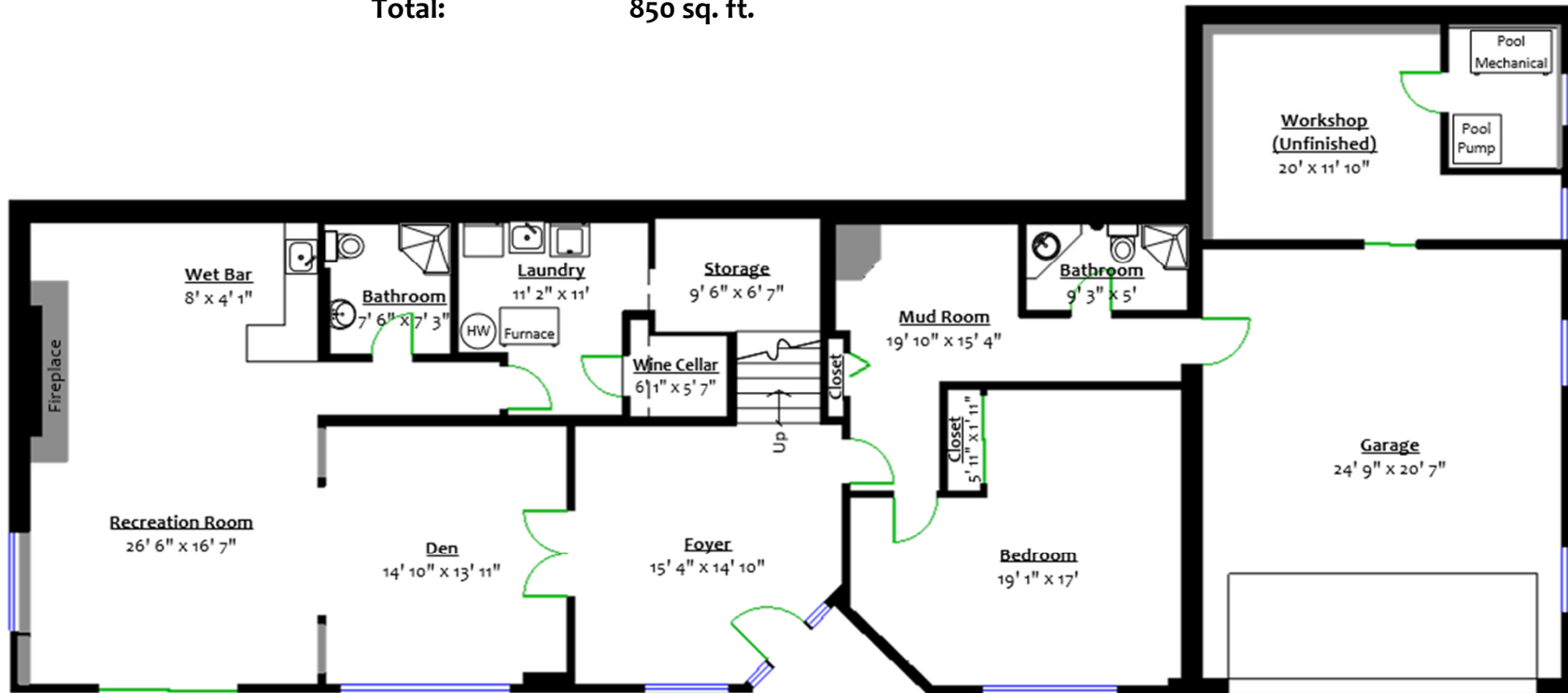

LOWER LEVEL

Floor Area: 1,916 Sq. Ft.
 Ceiling Height: 8' 3"

