

# CLARENCE DEBELLE

Personal Real Estate Corporation

West Vancouver's Luxury Home Real Estate Agent!



Tel.: 604-726-5780  
www.clarencedebelle.com

## 1182 Eyremount Drive, West Vancouver

TOTALS	
Main Floor:	2,895 sq.ft.
Upper Floor:	2,126 sq.ft.
Lower Floor:	3,449 sq.ft.
<b>HOME TOTAL:</b>	<b>8,470 sq.ft.</b>

Other Areas:	
Main Floor Porch:	172 sq.ft.
Main Floor Balconies:	1,035 sq.ft.
Upper Floor Balconies:	1,161 sq.ft.
Lower Floor Patios:	2,334 sq.ft.
3-Car Garage:	558 sq.ft.
Pool Area:	493 sq.ft.

### Main Floor 2,895 sq.ft.

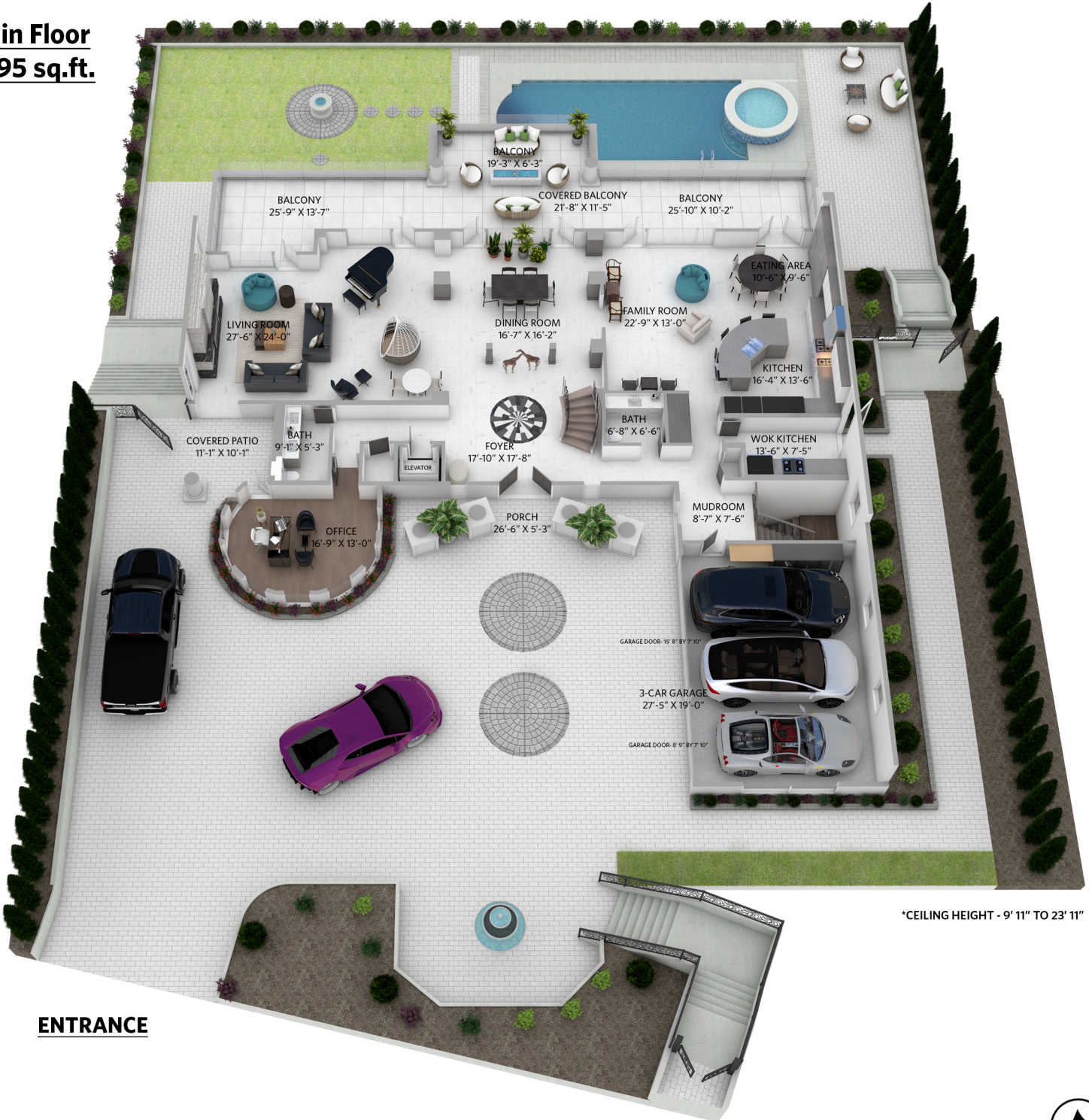

\*CEILING HEIGHT - 9' 11" TO 23' 11"

