

CLARENCE DEBELLE

Personal Real Estate Corporation

West Vancouver's Luxury Home Real Estate Agent!



Tel.: 604-726-5780
www.clarencedebelle.com

2580 Lloyd Avenue, North Vancouver

TOTALS		Other Areas:	
TOTAL:	1,475 sq.ft.	Porch:	64 sq.ft.
		Garage:	265 sq.ft.

Main Floor 1,475 sq.ft.

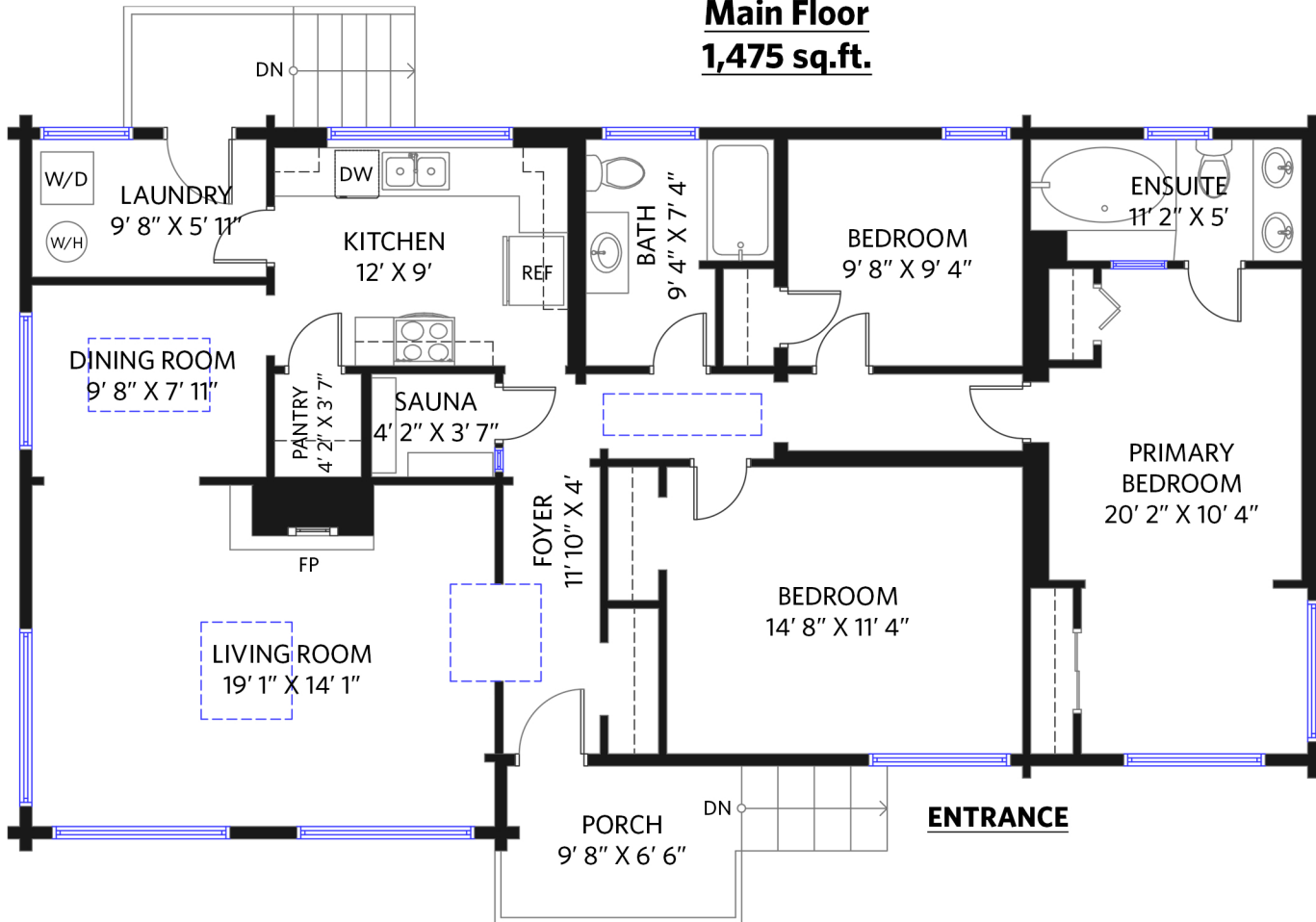

Garage 265 sq.ft.

