

# CLARENCE DEBELLE

Personal Real Estate Corporation

West Vancouver's Luxury Home Real Estate Agent!



Tel.: 604-726-5780  
www.clarencedebelle.com

## 835 EYRE MOUNT DRIVE, WEST VANCOUVER

TOTALS		Other Areas:	
Lower Floor:	3,396 sq.ft.	Front Porch:	78 sq.ft.
Main Floor:	3,545 sq.ft.	Patios:	3,332 sq.ft.
Upper Floor:	1,800 sq.ft.	Balconies:	165 sq.ft.
<b>TOTAL:</b>	<b>8,741 sq.ft.</b>	Garage:	775 sq.ft.
		Pool Room:	106 sq.ft.

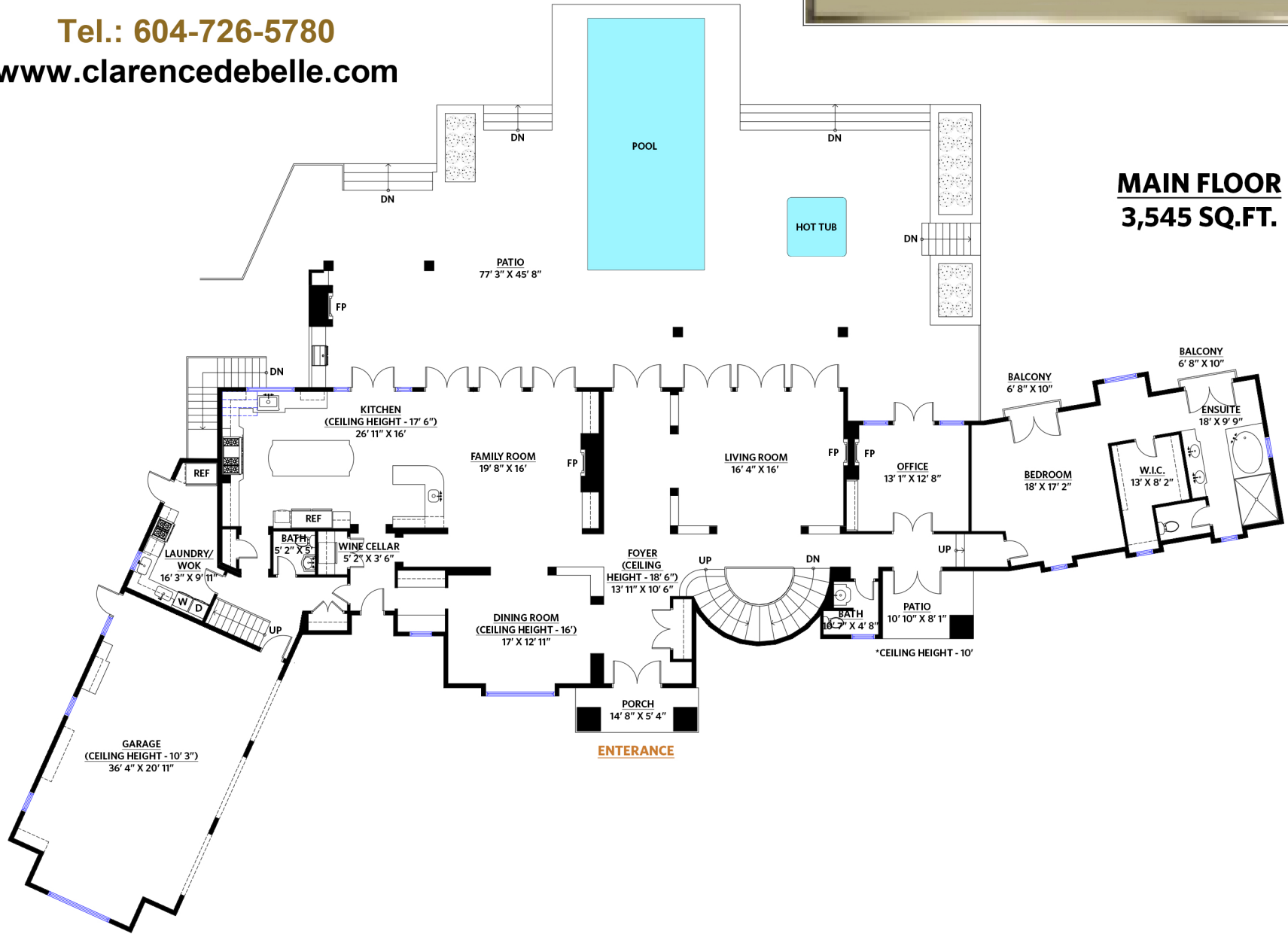

**MAIN FLOOR**  
**3,545 SQ.FT.**